



3 Beadmans Grove Newport, PO30 2FD

£275,000



Red Squirrel are please to offer this well presented Detached Family Sized Home, located within easy reach of Newport town centre, bus routes and local amenities. This home comprises good-sized lounge/diner, modern-fitted kitchen, downstairs cloakroom, two good-sized double bedrooms with the master benefitting from en-suite, a third single bedroom and family bathroom. Other benefits include a good-sized driveway, garage and easily maintainable gardens.

DETACHED HOUSE

3 BEDROOMS

MASTER EN-SUITE

DRIVEWAY & GARAGE

EASILY MAINTAINABLE GARDEN

CONSERVATORY

ROOMS

Entrance Hall

UPVC front door. Radiator. Two storage cupboards.
Doors & stairs off to:

Lounge/Diner 15' 8" x 13' 11" (4.77m x 4.24m)

Double glazed window to rear aspect. Radiator. Wood-effect laminate flooring. Double glazed door to rear aspect leading to conservatory.

Conservatory 14' 0" x 9' 2" (4.26m x 2.79m)

Radiator. Tiled flooring. Double glazed French doors to rear aspect leading to garden.

Kitchen 11' 1" x 8' 2" (3.38m x 2.49m)

Modern-fitted base & wall units. Integrated oven & induction hob. Double glazed window to front aspect.

Cloakroom

Low level WC. Pedestal wash hand basin. Radiator.

First Floor Landing

Radiator. Loft hatch access. Two storage cupboards.
Doors off to:

Bedroom 1 11' 6" x 12' 2" (3.50m x 3.71m)

Double glazed window to front aspect. Radiator. Door to en-suite:

En-suite

Shower enclosure. Radiator. Low level WC. Pedestal wash hand basin.

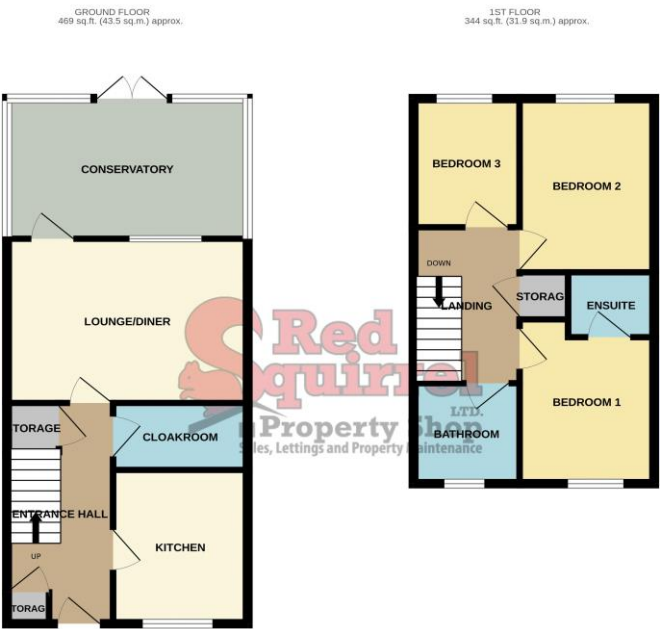

TOTAL FLOOR AREA - 812 sq ft (75.5 sq m.) approx.
Whilst every attempt has been made to ensure the accuracy of the floorplan contained herein, measurements of these, individual rooms and any other items are approximate and no responsibility is taken for any error, omission or mis-statement. This plan is for illustrative purposes only and should be used as such by any prospective purchaser. The accuracy, appropriateness and appearance of these plans and their content and its presentation are to their creditability or otherwise can be given. Made with Netpage (2012)

Bedroom 2 12' 10" x 8' 2" (3.91m x 2.49m)

Double glazed window to rear aspect. Radiator.

Bedroom 3 8' 11" x 7' 3" (2.72m x 2.21m)

Double glazed window to rear aspect. Radiator.

Bathroom 7' 2" x 6' 7" (2.18m x 2.01m)

Bath with over shower. Double glazed window to front aspect. Radiator. Low level WC. Pedestal wash hand basin.

